

6 Exploded View and Parts List

6-1 RS21A*

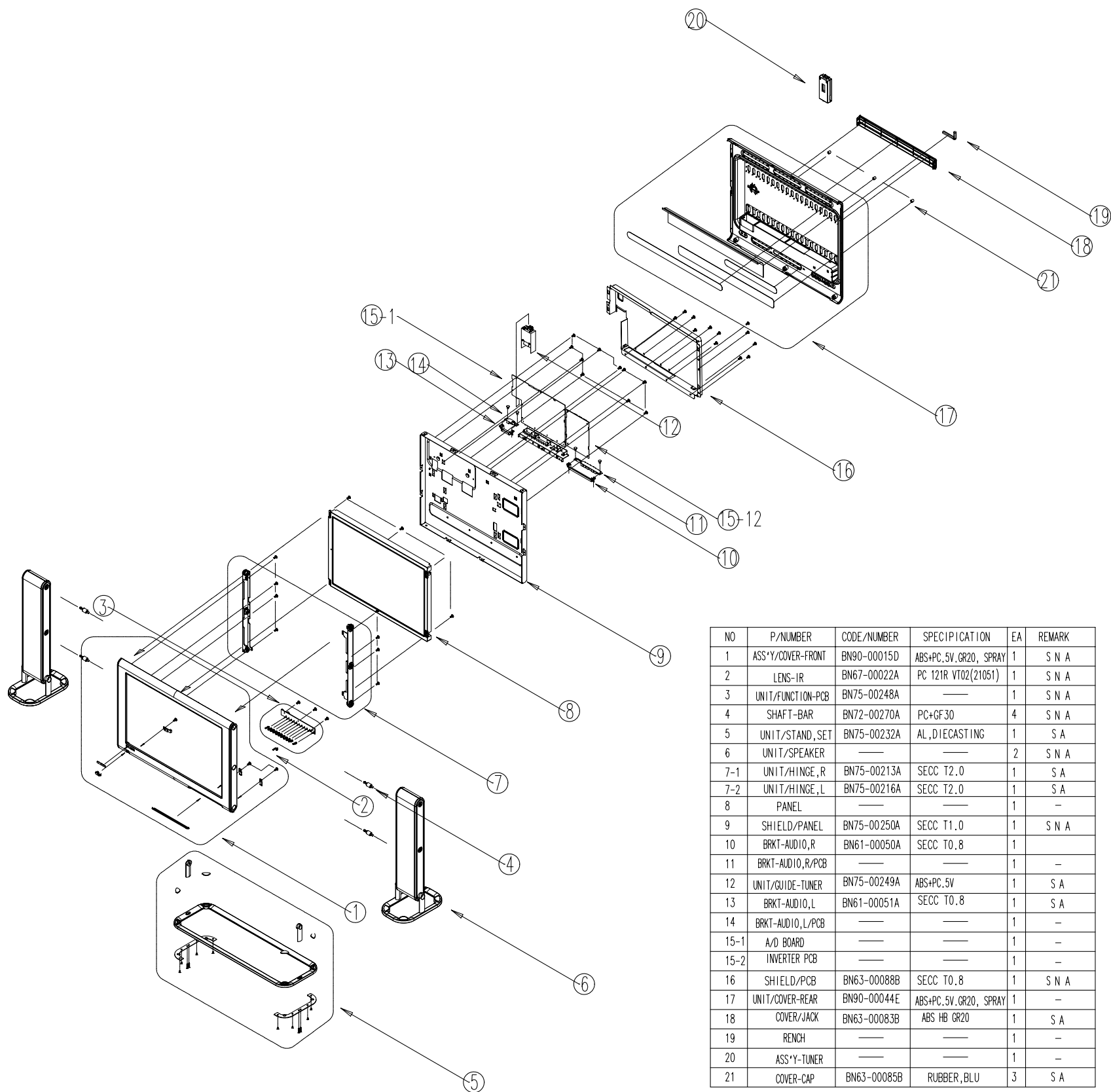

NO	P/NUMBER	CODE/NUMBER	SPECIFICATION	EA	REMARK
1	ASS'Y/COVER-FRONT	BN90-00015D	ABS+PC,5V,GR20, SPRAY	1	S N A
2	LENS-IR	BN67-00022A	PC 121R VT02(21051)	1	S N A
3	UNIT/FUNCTION-PCB	BN75-00248A	—	1	S N A
4	SHAFT-BAR	BN72-00270A	PC+GF30	4	S N A
5	UNIT/STAND, SET	BN75-00232A	AL ,DIECASTING	1	S A
6	UNIT/SPEAKER	—	—	2	S N A
7-1	UNIT/HINGE, R	BN75-00213A	SECC T2.0	1	S A
7-2	UNIT/HINGE, L	BN75-00216A	SECC T2.0	1	S A
8	PANEL	—	—	1	—
9	SHIELD/PANEL	BN75-00250A	SECC T1.0	1	S N A
10	BRKT-AUDIO, R	BN61-00050A	SECC T0.8	1	—
11	BRKT-AUDIO, R/PCB	—	—	1	—
12	UNIT/GUIDE-TUNER	BN75-00249A	ABS+PC,5V	1	S A
13	BRKT-AUDIO, L	BN61-00051A	SECC T0.8	1	S A
14	BRKT-AUDIO, L/PCB	—	—	1	—
15-1	A/D BOARD	—	—	1	—
15-2	INVERTER PCB	—	—	1	—
16	SHIELD/PCB	BN63-00088B	SECC T0.8	1	S N A
17	UNIT/COVER-REAR	BN90-00044E	ABS+PC,5V,GR20, SPRAY	1	—
18	COVER/JACK	BN63-00083B	ABS HB GR20	1	S A
19	RENC	—	—	1	—
20	ASS'Y-TUNER	—	—	1	—
21	COVER-CAP	BN63-00085B	RUBBER, BLU	3	S A

6-2 RS24A*

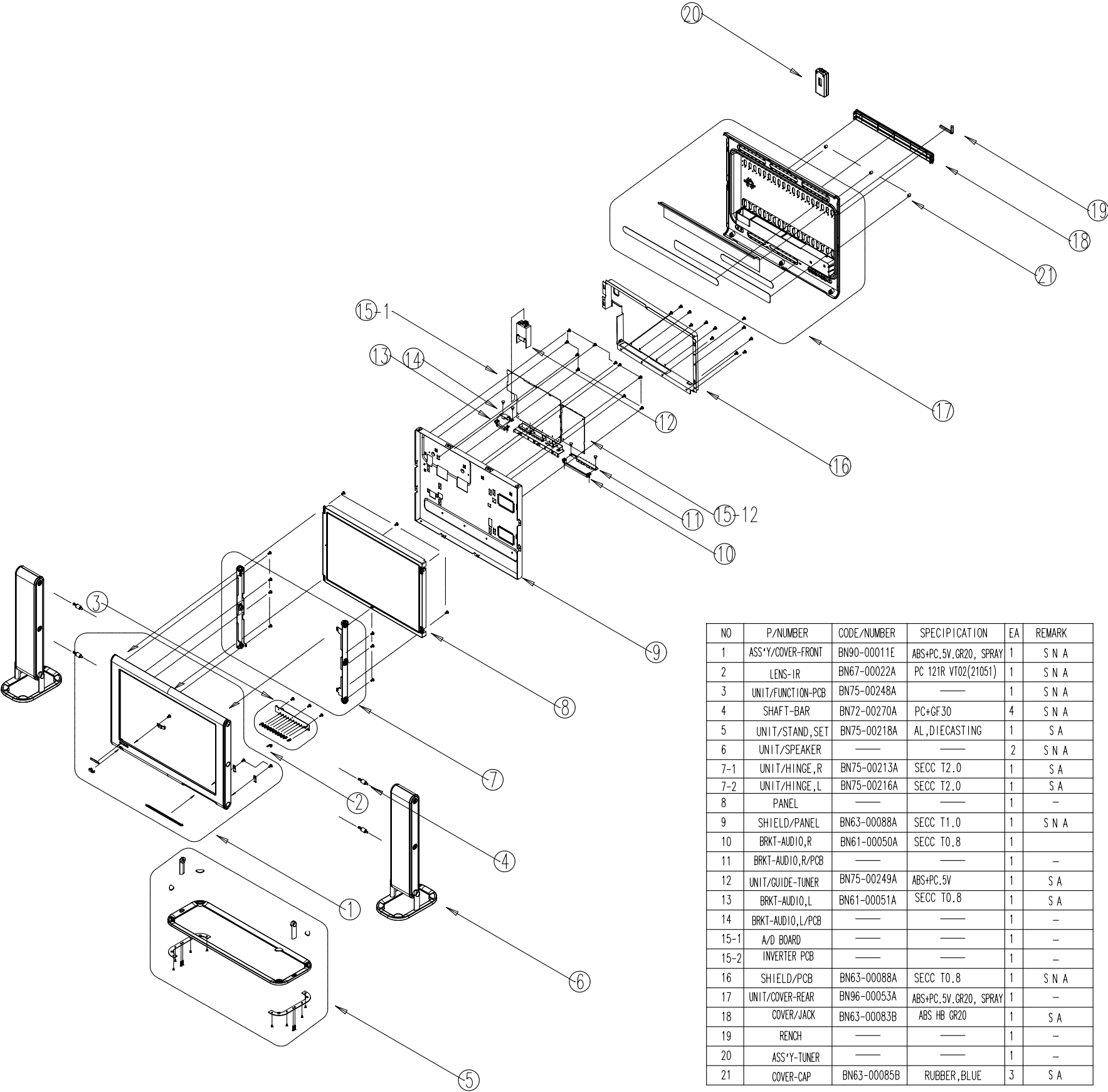

NO	P/NUMBER	CODE/NUMBER	SPECIFICATION	EA	REMARK
1	ASS'Y/COVER-FRONT	BN90-00011E	ABS+PC,5V,GR20, SPRAY	1	S N A
2	LENS-IR	BN67-00022A	PC 121R VT02(21051)	1	S N A
3	UNIT/FUNCTION-PCB	BN75-00248A	—	1	S N A
4	SHAFT-BAR	BN72-00270A	PC+GF30	4	S N A
5	UNIT/STAND, SET	BN75-00218A	AL,DIECASTING	1	S A
6	UNIT/SPEAKER	—	—	2	S N A
7-1	UNIT/HINGE,R	BN75-00213A	SECC T2.0	1	S A
7-2	UNIT/HINGE,L	BN75-00216A	SECC T2.0	1	S A
8	PANEL	—	—	1	—
9	SHIELD/PANEL	BN63-00088A	SECC T1.0	1	S N A
10	BRKT-AUDIO,R	BN61-00050A	SECC T0.8	1	—
11	BRKT-AUDIO,R/PCB	—	—	1	—
12	UNIT/GUIDE-TUNER	BN75-00249A	ABS+PC,5V	1	S A
13	BRKT-AUDIO,L	BN61-00051A	SECC T0.8	1	S A
14	BRKT-AUDIO,L/PCB	—	—	1	—
15-1	A/D BOARD	—	—	1	—
15-2	INVERTER PCB	—	—	1	—
16	SHIELD/PCB	BN63-00088A	SECC T0.8	1	S N A
17	UNIT/COVER-REAR	BN96-00053A	ABS+PC,5V,GR20, SPRAY	1	—
18	COVER/JACK	BN63-00083B	ABS HB GR20	1	S A
19	RENCH	—	—	1	—
20	ASS'Y-TUNER	—	—	1	—
21	COVER-CAP	BN63-00085B	RUBBER,BLUE	3	S A